

REPLACEMENT BATTERY TYPE:

Li-ion 6.4V 1500mAh.

BATTERY REPLACEMENT:

If after routine operation check, the lamp does not remain lit for the three hour period, a new battery pack may be required.

- 01) Switch off the electricity at the mains.
- 02) Allow batteries to fully discharge then reconnect to supply and allow to charge for 24 hours.
- 03) Test again for 3 hours, if light does not remain lit change the battery pack as follows:
- 04) Isolate the mains supply to the unit.
- 05) Remove the cover of emergency pack.
- 06) Unplug the battery lead.
- 07) Remove the battery pack.
- 08) Write current date on the new emergency pack.
- 09) Fit new battery pack.
- 10) Replace cover.
- 11) Restore power and allow to charge for 24 hours.
- 12) Perform operation check and update test record.

IMPORTANT NOTES:

The battery charging circuit and components are separated from the mains by at least basic (single layer) insulation.

When energised by a constant mains supply, the battery will be constantly charged whether or not the lamp is illuminated. On failure of the constant mains supply, the fitting will switch automatically using transistorised switching from battery charging to battery discharge powering the lamp whether or not the lamp was illuminated before the power failure.

EVENTUALLY, YOU MAY WANT TO REPLACE THIS PRODUCT:

Regulations require the recycling of Waste from Electrical and Electronic Equipment (European "WEEE Directive" effective August 2005—UK WEEE Regulations effective 2nd January 2007). Environment Agency Registered Producer: WEE/GA0248QZ.

WHEN YOUR PRODUCT COMES TO THE END OF ITS LIFE OR YOU CHOOSE TO REPLACE IT, PLEASE RECYCLE IT WHERE FACILITIES EXIST - DO NOT DISPOSE WITH HOUSEHOLD WASTE.

INDUSTRIAL BATTERIES:

Within certain products Eterna Lighting Ltd places lead acid, lithium ion, nickel cadmium & nickel metal hydride batteries on the market. Industrial batteries are subject to waste regulation under the Waste Batteries and Accumulators Regulations 2009 and should be disposed of responsibly. Purchasers may be able to dispose of their waste industrial batteries locally via legitimate licensed trade waste contractors. Eterna is obliged to take back, free of charge and within a reasonable time, waste industrial batteries of the same chemistry supplied to a Purchaser, for treatment and recycling and is required to do this in any calendar year new industrial batteries are placed on the market. In certain circumstances, this may include batteries not originally supplied by Eterna. If any Purchaser requires Eterna to take back Industrial batteries, they should write to the Operations Director, Eterna Lighting Ltd, Huxley Close, NN8 6AB, who will then advise on the necessary arrangements for the receipt, proper treatment and recycling of, the waste industrial batteries.

CLEANING:

Clean this fitting only with a soft dry cloth.

Do not use any chemical or abrasive cleaners.

IF YOU EXPERIENCE PROBLEMS:

If you believe your product is defective, please return it to the place where you bought it. Our Technical Team will gladly advise on any Eterna Lighting product, but may not be able to give specific instructions regarding individual installations.



INSTALLATION INSTRUCTIONS

A guide for qualified electricians

3 HOURS DURATION IN EMERGENCY MODE



Pack contents:

- 1 x Emergency pack
- 1 x Maintenance check record
- 1 x Male connector
- 1 x Female connector

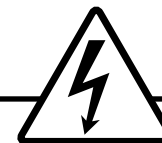

DANGER!

NOTE: this unit has a permanent live mains supply, please ensure you isolate before removing cover. There is also a separate switched supply that controls the emergency lighting fitting - this also needs to be isolated.

Model:

KBATPLI / EBPM3LI

Lithium-Ion Emergency Battery Pack

These instructions are provided as a guideline to assist you.

**PLEASE READ THESE INSTRUCTIONS BEFORE INSTALLATION
AND RETAIN FOR FUTURE REFERENCE**



Email: sales@eterna-lighting.co.uk / technical@eterna-lighting.co.uk

Visit our website: www.eterna-lighting.co.uk

Made in China

READ THIS FIRST:

Check the pack and make sure you have all of the parts listed on the front of this booklet. If not, contact the outlet where you bought this product.

This fitting must be installed by a competent person in accordance with the current building and IEE wiring regulations.

As the buyer, installer and/or user of this product it is your own responsibility to ensure that this fitting is fit for the purpose for which you have intended it. Eterna Lighting cannot accept any liability for loss, damage or premature failure resulting from inappropriate use.

Switch off the mains before commencing installation and remove the appropriate circuit fuse or lock of MCB.

Disconnect from the electrical supply before flash or high voltage testing.

This unit is suitable for indoor use only.

Do not cover the fitting with any insulating materials.

This product is designed for permanent connection to fixed wiring; this should be a suitable circuit (protected with the appropriate MCB or fuse)

When making connections, ensure that the terminals are tightened securely and that no strands of wire protrude. Check that the terminals are tightened onto the bared conductors and not onto any insulation.

This product is double insulated. **DO NOT CONNECT ANY PART TO EARTH.**

Connect the luminaire driver to the terminal block according to the attached wiring diagram.

You are advised at every stage of your installation to double-check any electrical connections you have made. After you have completed your installation there are electrical tests that should be carried out: these tests are specified in the Wiring Regulations (BS7671) referred to in the Building Regulations.

The batteries supplied with this fitting are a consumable part and therefore may be outside of any warranty offered.

INSTALLATION:

Please also refer to the included wiring diagram guide (on a separate page).

DANGER! Please note that there are two live supplies, one switched and one permanent; please ensure you isolate both before you undertake any work on the emergency fitting.

- 01) Switch off the mains before commencing installation and remove the appropriate circuit fuse or MCB.
- 02) Site the emergency pack within one metre of the luminaire to be converted.
- 03) Connect the luminaire driver to the terminal block according to the attached wiring diagram.
- 04) Refer to attached wiring guide diagram: Male and female plug/socket connectors are provided to complete the driver to luminaire circuit as required.

If LED driver output connector is a Female socket then plug Male connector lead into this and connect the cable into 'LED Driver Output' on the Emergency Module.

Connect the Female connector Lead to the lead from LED luminaire and wire into 'Output to LEDs' on the emergency module.

OR

If LED driver output connector is a Male plug then connect with Female connector lead and wire this into 'LED Driver Output' on the emergency module.

Connect the Male connector lead to the lead from LED luminaire and wire into 'Output to LEDs' on the emergency module.

- 05) Make the electrical connections to the terminal block according to the markings, (also refer to attached wiring diagram)

Permanent Live
Switched Live
Neutral
- 06) Ensure the battery plug is connected to the socket on the Emergency Module.
- 07) If the luminaire has a position for the LED indicator (such as in an LED panel) remove the indicator bezel, insert the indicator into the grommet and secure with a cable tie. See FIG 1.

OR

Remove the LED indicator from the bezel, drill Ø20mm hole in suitable position close to the luminaire. Insert the bezel into the hole and reattach LED Indicator. See FIG 2.

The green LED should be visible when the light is on.

- 08) Mark the current date on the battery pack.
- 09) Connect 240V mains permanent and switch supply to the battery pack.
- 10) Restore power; a green indicator light will be present to show that the batteries are charging.

OPERATION CHECKS:

Periodic testing should be carried out to ensure emergency lighting is operating correctly. Interruption of the supply, causing the fitting to be energised from the battery, should be carried out by the operation of a local keyswitch or other isolation device. During this period all fittings should be examined visually to ensure that they are functioning correctly. At the end of the test period the supply shall be restored and all indicator lamps or devices checked to ensure that the normal supply has been restored.

DAILY:

Visual inspection of the battery charge LED.

EACH MONTH:

Isolate the power supply for a period sufficient to ensure that each lamp is illuminated. Endorse the test record form supplied.

ONCE EACH YEAR:

Isolate the power supply and check that the light is still illuminated after 3 hours. Endorse the test record form.

Because of the possibility of a failure of the normal lighting supply occurring shortly after a period of testing of the emergency lighting system or during the subsequent recharge period, all full duration tests shall wherever possible be undertaken preceding time of low risk to allow for battery recharge.

NOTE: please keep this instruction booklet and the test record in a safe place. A fire officer or other authorised person may want to see your record of inspection and testing.

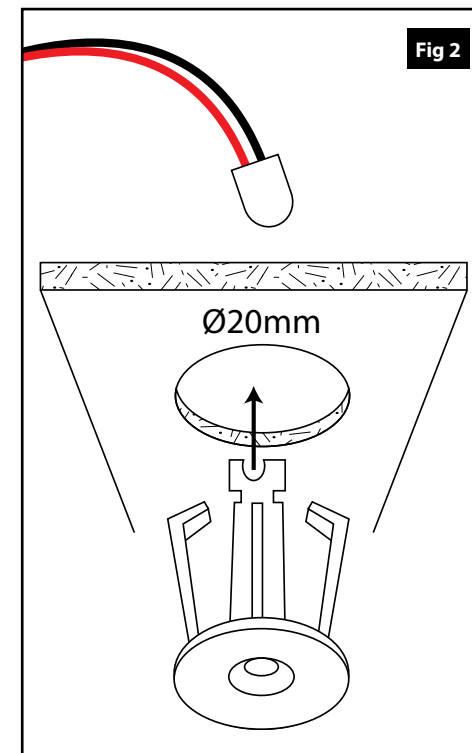
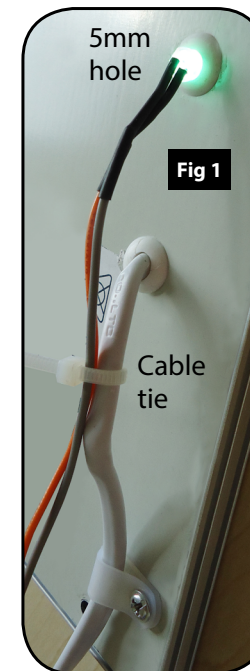

KBATPLI / EBPM3LI - LED Luminaire Wiring Guide Diagram

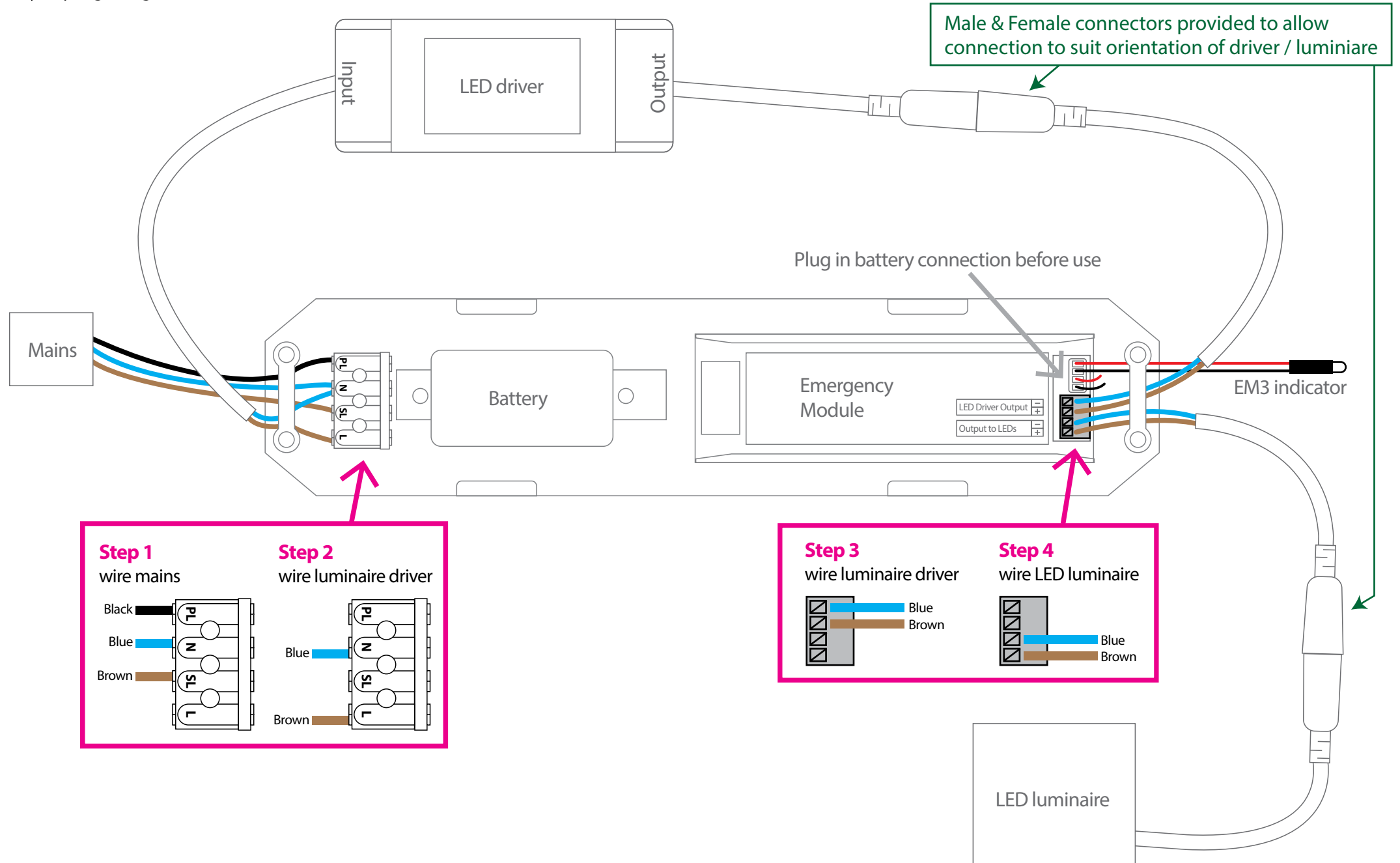



INSTALLATION, MAINTENANCE AND OPERATION CHECK RECORD

Installed
By:

[illegible]