



5  
Year Warranty



Emergency  
Product



LiFePO4 Battery



✓ IES Files



Double  
Insulated



Hole  
Knockouts

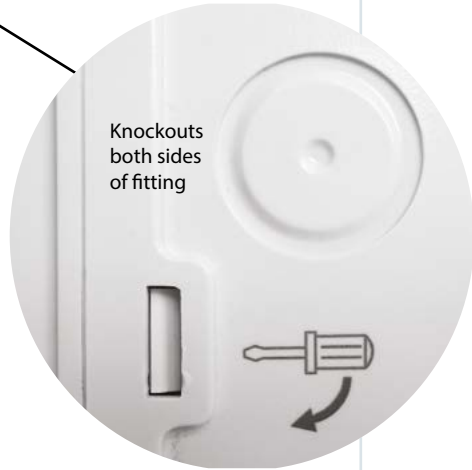

**LiFePO4 COMPACT LED EMERGENCY TWINSPLI**

- Polycarbonate construction • Push fit terminals
- Individual indicator to show healthy charge to battery
- Horizontally and vertically adjustable heads, 180° rotation across the horizontal plane
- Minimum 3 hour functionality in emergency mode
- Battery: LiFePO4 3.2V 4500mAh
- Battery 5 year warranty - Replacement battery code: EB18

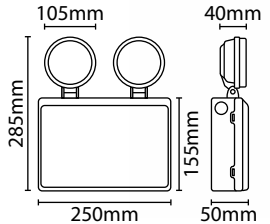

Code	Wattage	Colour Temp.	Lumens	Avg. Rated Life (Hrs)	IP Rating	MOM / OPQ
KTWINSPLI	2W	6300K	420 lm	40,000 hrs	IP20	1 / 20